

GALT-F Folding Pocket Door System (Inset)



Door Width	Max. 450 mm
Door Height	Max. 1830 mm
Door Thickness	23 ~ 30 mm
Door Weight	Max. 10 kg/Door

With use of additional parts, door height max, 2400 mm (max 10kg / door) is possible. please contact [Gripwell](http://gripwell.com) for the details

Features

- Folding door is stored inside the cabinet.

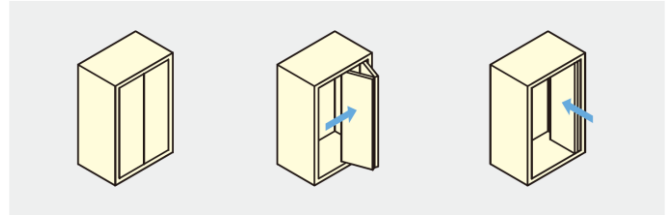

Top View

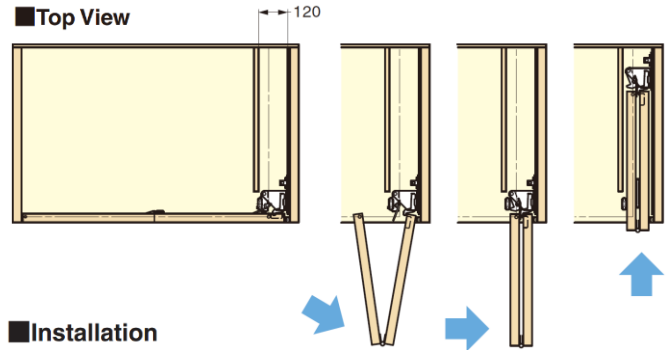

Installation

Door storing
355.6 (GALT-F18)
406.4 (GALT-F20)

Rail Dimensions

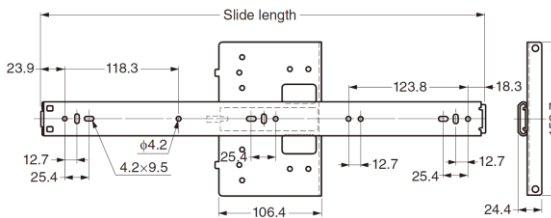

Part No.	Opening	Rail Length	Door Storing	Cabinet Depth
GALT-F18L	Left	460.4	355.6	Min. 466.7 + Door Thickness
GALT-F18R	Right			
GALT-F20L	Left	511.2	406.4	Min. 517.5 + Door Thickness
GALT-F20R	Right			

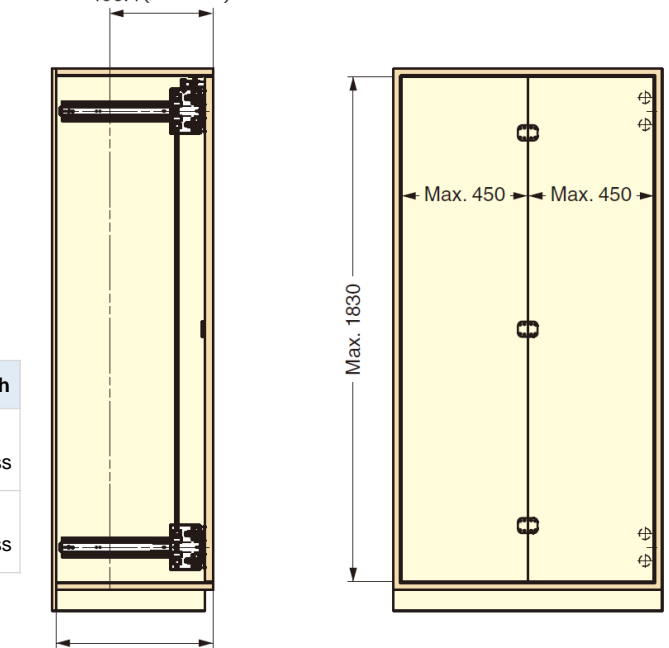

Min. cabinet depth
Min. 466.7 + Door thickness (GALT-F18)
Min. 517.5 + Door thickness (GALT-F20)

Parts Set

Necessary Parts

Please refer to "Qty [a]~[d]" for parts included in each set.

Set Name	Part No.
a Left Opening (Door Storing 355.6)	GALT-F18L
b Right Opening (Door Storing 355.6)	GALT-F18R
c Left Opening (Door Storing 406.4)	GALT-F20L
d Right Opening (Door Storing 406.4)	GALT-F20R

Parts Included

No.	Qty	Part Name	Dimensions	Description
1	2 pcs	Rail		<ul style="list-style-type: none"> Material Steel Finish Black Chromate
2	2 pcs	Rack		<ul style="list-style-type: none"> Material ABS Finish Black
3	1 pc	Cap		<ul style="list-style-type: none"> Material Steel Finish Black Chromate
4	4 pcs	Gear		<ul style="list-style-type: none"> Material POM Finish Black
5	4 pcs	Bush		<ul style="list-style-type: none"> Material POM Finish Black
6	4 pcs	Stationary Block		<ul style="list-style-type: none"> Material POM Finish Black <p>Screw : Binding Head Self Tapping Screw UNC8-32</p>
7	2 pcs			<ul style="list-style-type: none"> Material PA Finish Black <p>Screw : Countersunk Head Tapping Screw 4.2×32</p> <p>Not for GALT-F This part is not used</p>
8	1 pc	Upper Rail Joint		<ul style="list-style-type: none"> Material POM Finish White
9	1 pc	End Guide		<ul style="list-style-type: none"> Material Steel (SPCC) / POM Finish Yellow Zinc Chromate / Natural
10	1 pc	Angle Stopper		<ul style="list-style-type: none"> Material Steel (SPCC) Finish Nickel

No.	Qty	Part Name	Dimensions	Description
11	1 pc	Inner Guide		<ul style="list-style-type: none"> Material POM Finish White
12	1 pc	Interlock		<ul style="list-style-type: none"> Material Steel / POM Finish Black / White <p>Right type shown.</p>
13	3 pcs	Centre Hinge		<ul style="list-style-type: none"> Material Steel Finish Black <p>Screw : Countersunk Head Tapping Screw 3.5×16</p>
14	1 pc	Hinge Cover Bracket		<ul style="list-style-type: none"> Material Steel (SPCC) Finish Black Paint
15	2 set (4 pcs)	Hinge Set		GALT-F-8086HKEZX <ul style="list-style-type: none"> Material Steel / Zinc Alloy Finish Yellow Zinc Chromate / Black

Rail

Necessary Parts

1 pc is necessary for a pair of doors.

No.	Qty	Part No.	Part Name	Dimensions	Description
16	1 pc	GFD30-HBR1820SIL	Upper Rail (1820 mm)		<ul style="list-style-type: none"> Material Aluminium Finish Anodized Silver <p>Bore Pitch : Approx. 300 mm Pitch End : Approx. 30 mm</p>
17	1 pc	GFD30-HBRT1500SIL	Bottom Guide Rail (1500 mm)		<ul style="list-style-type: none"> Material Aluminium Finish Anodized Silver

Shaft

Necessary Parts

1 pc is necessary for a pair of doors.

No.	Length	Qty	Part No.	Part Name	Dimensions	Description
18	902±13 mm	1 pc	G29475-36	Shaft		<ul style="list-style-type: none"> Material Steel Finish Black Chromate
19	1207±13 mm	1 pc	G29475-48			
20	1816±13 mm	1 pc	G29475-72			